

FORTY3 BASIN FO055BI

CE EN 14688:2015

GLOBO

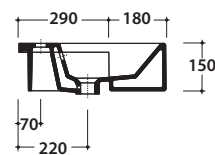
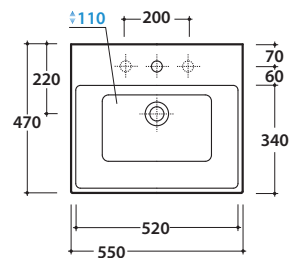

Ceramic antibacterial effect
BATAFORM®



Glazed product with
CERASLIDE®

Cod. **FO055BI**

Basin 55.47 h15 cm. Semirecessed installation. Weight 17 Kg



Cod. **FI012BI**

Push open valve drain with ceramic top for basins with overflow. Weight 0,5 Kg



Cod. **FI012CR**

Push open chromed valve drain for basins with overflow. Weight 0,5 Kg