

kaldewei baths

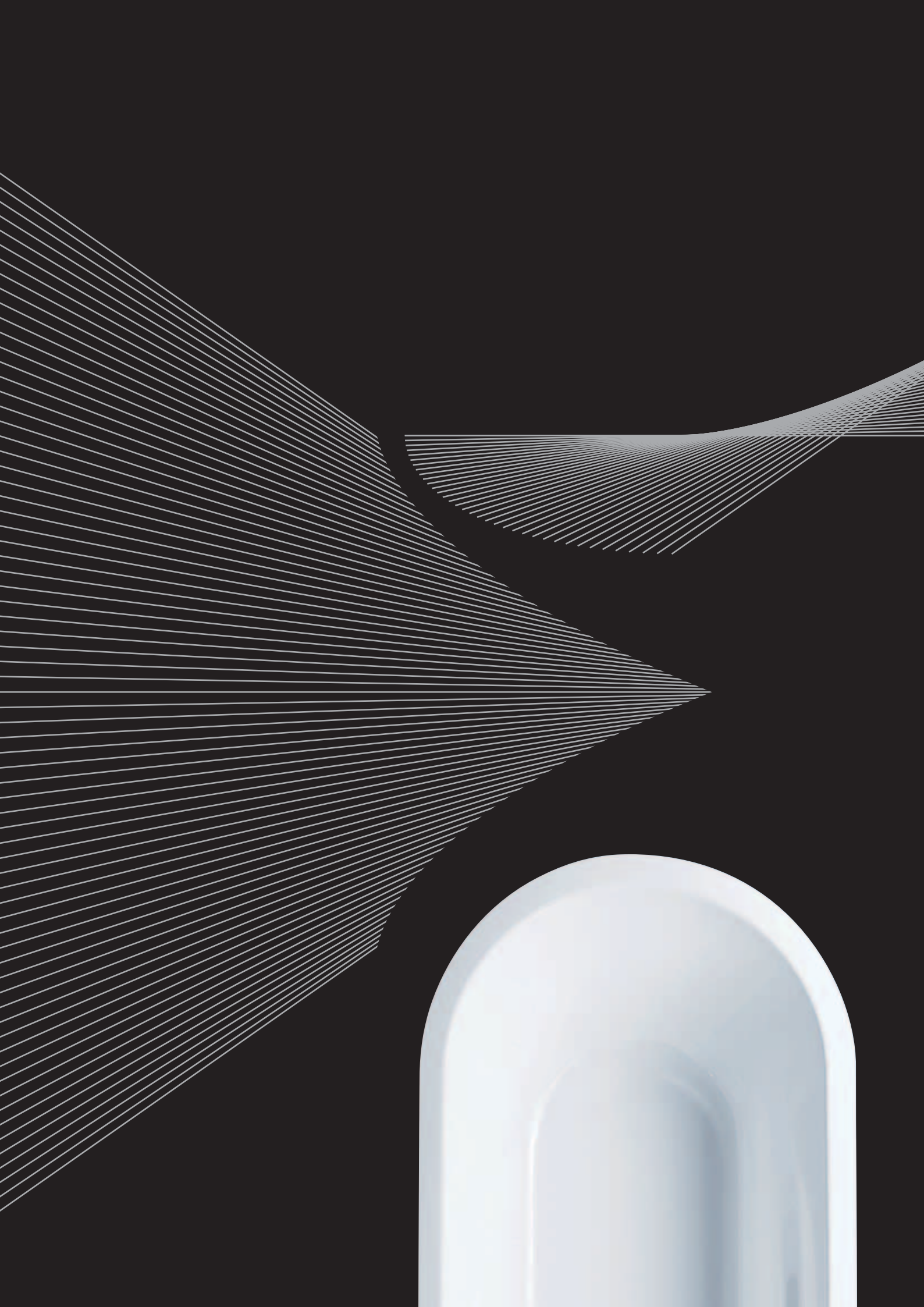



the kaldewei difference

The Kaldewei family encompasses a range of elegant baths based on a single classic design. The range as a whole is designed to meet the widest range of bathroom requirements.

The strength in design of the range builds on the quality that Kaldewei baths are known for. Each bath is constructed from 3.5mm porcelain enamelled steel. Blending beauty and flexibility with virtual indestructability, this proven combination of strength and smoothness guarantees at least 30 years of unblemished performance. A clever design that not only maximises space and minimises water volumes but also has an inherent beauty makes Kaldewei the selection for both the design conscious and the family focussed.





Sanilux.
model 342/343
1700 x 750 x 430

Designed for total comfort and relaxation, the Sanilux features a gentle rounded curve to perfectly support the neck.



Vaio.
model 960
1700 x 800 x 430

This classically proportioned bath features a distinctive contoured interior that brings a touch of charm to the bathroom.



Vaioduo Rectangular.
model 950
1800 x 800 x 430

Classic lines and beautifully finished, this twin person bath is the perfect solution for any bathroom.



Vaioduo Oval.
model 951
1800 x 800 x 430

A timeless design that can be installed inset or freestanding, this is the perfect bathroom centrepiece.

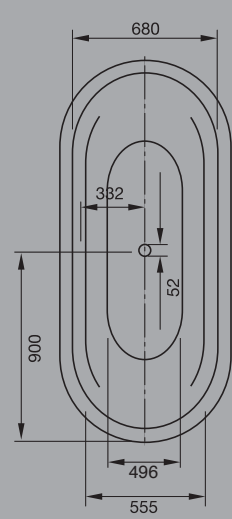
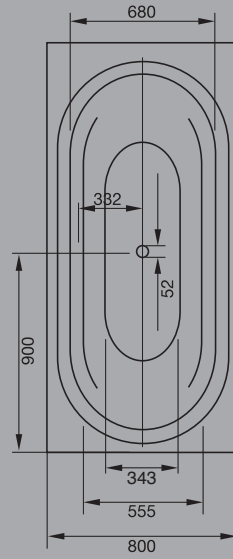
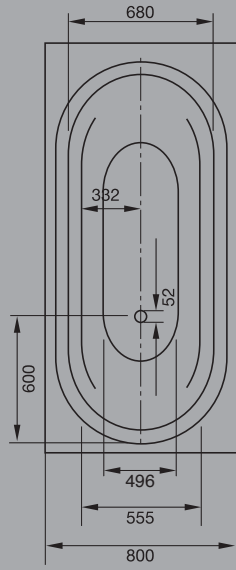
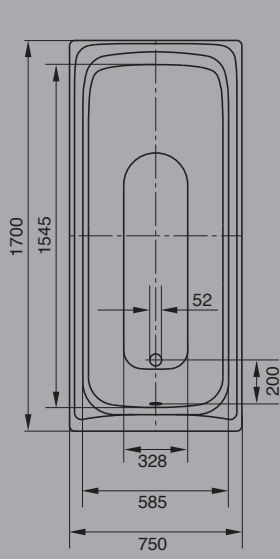



Vaiostar.
model 961
 1700 x 800 x 430

A unique and versatile design, perfect for when it comes to showering or bathing for two. Ergonomically placed handles make it easy to step out.



Vaioset.
model 954
 1700 x 750 x 430
model 956
 1600 x 700 x 430

This popular double-ended bath incorporates a clever design that maximises the flat standing area for showering.



Vaio 3.
model 962
 1400 x 1400 x 430

The classic design with a 3-fold function. Beautifully spacious, a water saving design and the epitome of luxury.

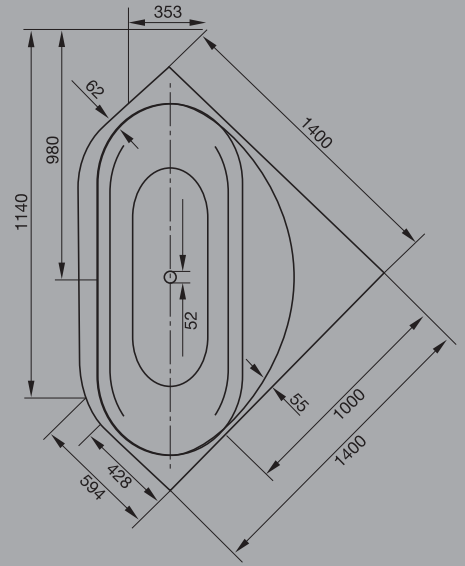
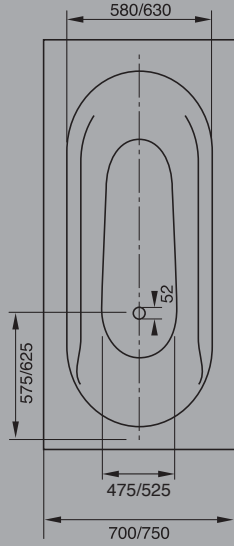
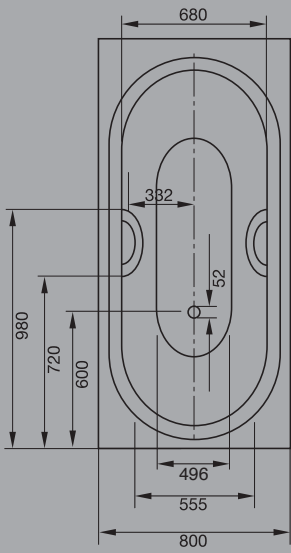



more vaio difference

The Vaioduo Oval and Vaioduo Rectangular models are available with a seamless skirt, transforming them into a stunning freestanding centrepiece.

These classic models are all available with chrome pop up waste with overflow and sound deadening pads. And for flexibility, all rectangular models come standard with a tiling lip to allow for island or "tiled-in" installation.

All baths are available with legs (sold separately) for a fully supported installation. This height adjustable option not only saves on cement bedding and makes levelling quick and easy, but it also provides better thermal insulation for a longer lasting experience.



18 good reasons

to choose Kaldewei 3.5 mm steel enamel

A bath is usually fixed into the bathroom structure, therefore, the right choice of bath will directly determine the lifespan of the bathroom. The bath is the one item with the potential to provide the user with a sense of physical enjoyment.

1. Comfort

The principle of ergonomics is applied to all Kaldewei baths to ensure maximum bathing comfort in every design.

2. Proprietary enamel production

In order to guarantee the consistent high quality of our steel enamel baths, Kaldewei is the only manufacturer to make its enamel according to its own formula.

3. Stability through 3.5 mm steel enamel

The especially thick 3.5 mm* steel enamel gives Kaldewei products unsurpassed stability and security.

4. Scratch and abrasion resistant

Kaldewei baths cannot be scratched by objects usually found in the bathroom, such as nail scissors, nail files or similar. Because if metal comes into contact with enamel, it is the metal that rubs off while the enamel remains unchanged.

5. Hard and impact resistant

Extensive tests have shown that the thickness of the enamel layers and their composition guarantee high impact resistance. In everyday use, this means that there is no need to worry if something falls into the bath.

6. Constant water temperature

Steel is an excellent heat conductor and quickly assumes the temperature of the water—the heavier gauge the better. Heat absorbed by the steel flows back into the water as the water cools down. The temperature of the water in the bath thus remains relatively constant for a long time. Bath leg installation systems provide for additional thermal insulation.

7. Hygienic and easy-care

Kaldewei porcelain enamel is a glass-hard bath surface that is almost impossible to scratch which means it stays impervious to bacterial contamination and is a safer more sanitary surface that is easy to maintain.

8. Glass-like

Kaldewei steel enamel possesses the same properties as real glass shower screens, tiles and ceramic, so that all the materials in the bathroom have a uniform appearance and lifetime expectations.

9. Quiet

Thanks to a material thickness of 3.5 mm,* water runs into the bath quietly and sound is muffled much better than in thin metal baths.

10. Colourfast and lightfast

Enamel is colourfast and resistant to UV light and thus extremely resistant to ageing; the colour effect (shine and structure) and colour metamery (change in colour as a result of different actions of light) of enamel are exactly the same as those of ceramic glazes.

11. Acid and chemical resistant

Kaldewei steel enamel is acid resistant and resistant to all cosmetic and medicinal bathing preparations and perfumes. These substances thus cause no material changes or stains on the surface.

12. Heat resistant

Burning or smouldering objects (e.g. cigarettes or candles) leave no burn marks or traces of smoke on Kaldewei steel enamel.

13. No static charge

Since baths made of Kaldewei steel enamel do not charge up with static electricity, they do not attract dust. This means that they always shine and are quick to clean.

14. Minimal material expansion

Unlike acrylic Kaldewei baths have virtually no expansion or contraction when subjected to temperature fluctuations. Hence, expansion causes no cracks in the joints or structural damage due to moisture.

15. Easy to seal

Tile layers will have no problem sealing baths made of steel enamel as compared to acrylic baths. Permanent elastic joint sealer bonds to Kaldewei steel enamel without pre-treatment. 'Tile-seal' is supplied to ensure the flat-edged baths conform to Australian Standards when abutting to wall.

16. Repairs

Damage to the surface of the enamel can be repaired with special repair kits from the Kaldewei accessory programme.

17. Guarantee

30-year guarantee in accordance with a guarantee certificate is supplied on all baths and shower trays made of Kaldewei steel enamel.

18. Lasting value and long life

If cared for correctly, a bath made of Kaldewei steel enamel looks almost as it did on the first day, even decades later.

**3.5 mm steel enamel produced from 2.9 mm ± 0.14 mm steel*

Your bathroom. Your life.™

Visit any one of our 300 showrooms around Australia for all the latest products, concepts and inspiration to make your bathroom whatever you want it to be. And for the ultimate bathroom experience, go to one of our new bathroom life™ stores where you will find the biggest range of leading Australian and international brands.

Call **1800 032 566** or visit **www.reece.com.au** for your nearest bathroom showroom.

Due to limitations in the printing process the colours in this brochure are a guide only. The manufacturer/distributor reserves the right to vary specifications or delete models from their range without prior notification. The manufacturer/distributor takes no responsibility for printing errors. 12 months parts and labour warranty.

V3 [BROCHURE CODE 9501298]



KALDEWEI
Europe's No.1 for baths

